

Flex-Master 250 Hose Assemblies

Streamline's Flex-Master 250 was engineered to be a safe, stable and economical washdown hose. The lightest, easiest handling hose in its pressure class.

- Backed by safety margins that exceed the industries standard 4:1 ratio.
 - Rated at 250psi-200°F
 - New high-tech horizontal braiding and high-strength textile filaments applied at precise angles eliminated the weight, yet increases strength.
 - Abrasion-resistant Neoprene Cover with the sure-grip impression wrapped finish protects the hose from the hazards of chemicals, fats, and moisture.
- Flex-master 250 gives you better flexibility, easier handling, and a new standard for strength in lightweight construction.



All Flex-Master 250 hose assemblies are furnished with stainless steel internal spring guards, and roughneck ferrules at both ends. Standard hose end fittings are 1/2" male NPT spt swivel at one end, and a 3-piece 3/4" male NPT source fitting at the other end. Hoses available in black, red and white.

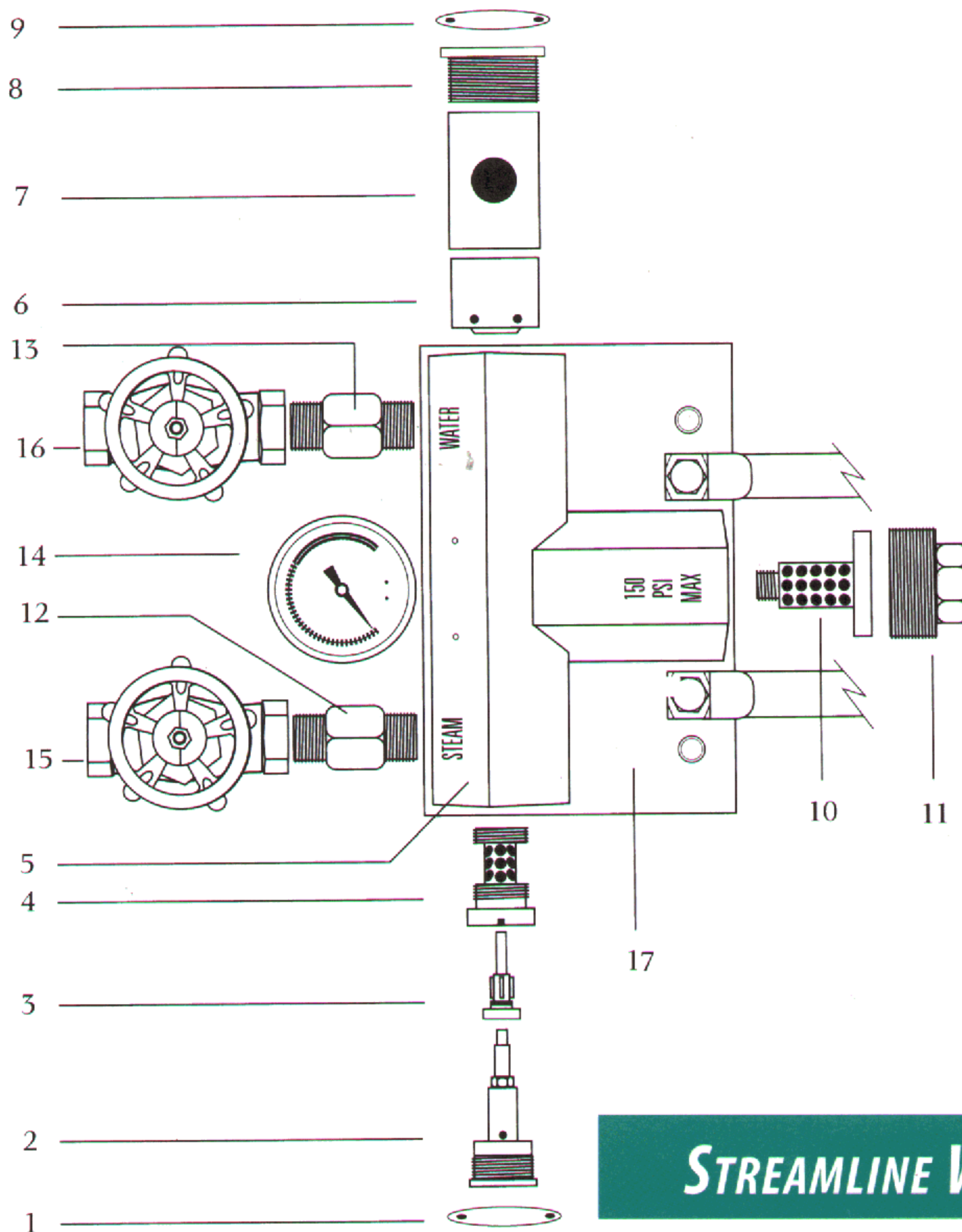

Parts List • Steammaster 2000

- 1 Steam I.D. Tag (ALUM.)
- 2 Poppet Actuator (BRASS/SS)
- 3 Steam Poppet (SS)
- 4 Steam Injector (SS)
- 5 Mixer Body (BRZ or SS)
- 6 Water Thrust Cup (SS)
- 7 Thrust Cup Housing (BRASS)
- 8 End Adaptor (SS)
- 9 Water I.D. Tag (ALUM.)
- 10 Steam Diffuser (SS)
- 11 Hose Adaptor (SS)
- 12 Steam Check Valve (BRASS or SS)
- 13 Water Check Valve (BRASS or SS)
- 14 Temperature Gauge (SS)
- 15 Steam Control Valve (BRZ or SS)
- 16 Water Control Valve (BRZ or SS)
- 17 Mounting Bracket (ALUM.)

Material Selection Codes

- SS Stainless Steel Body & Valves
 PSS Polished Stainless Steel Body and Valves
 BRZ Bronze Body and Valves

STREAMLINE WASHDOWN EQUIPMENT, INC.

5325 Avenida Encinas • Carlsbad, CA 92008

Toll Free (800) 926-3648 • (760) 431-7035 • Fax (760) 431-7081

We Don't Just Build Product... We Continually Perfect Them.

